

# MAPLE RIDGE, MAPLE RIDGE, MAPLE RIDGE, BC, V2X 3E4

<https://www.soldbyksandhu.com>

Maple Ridge, Maple Ridge, Maple Ridge, BC, V2X 3E4

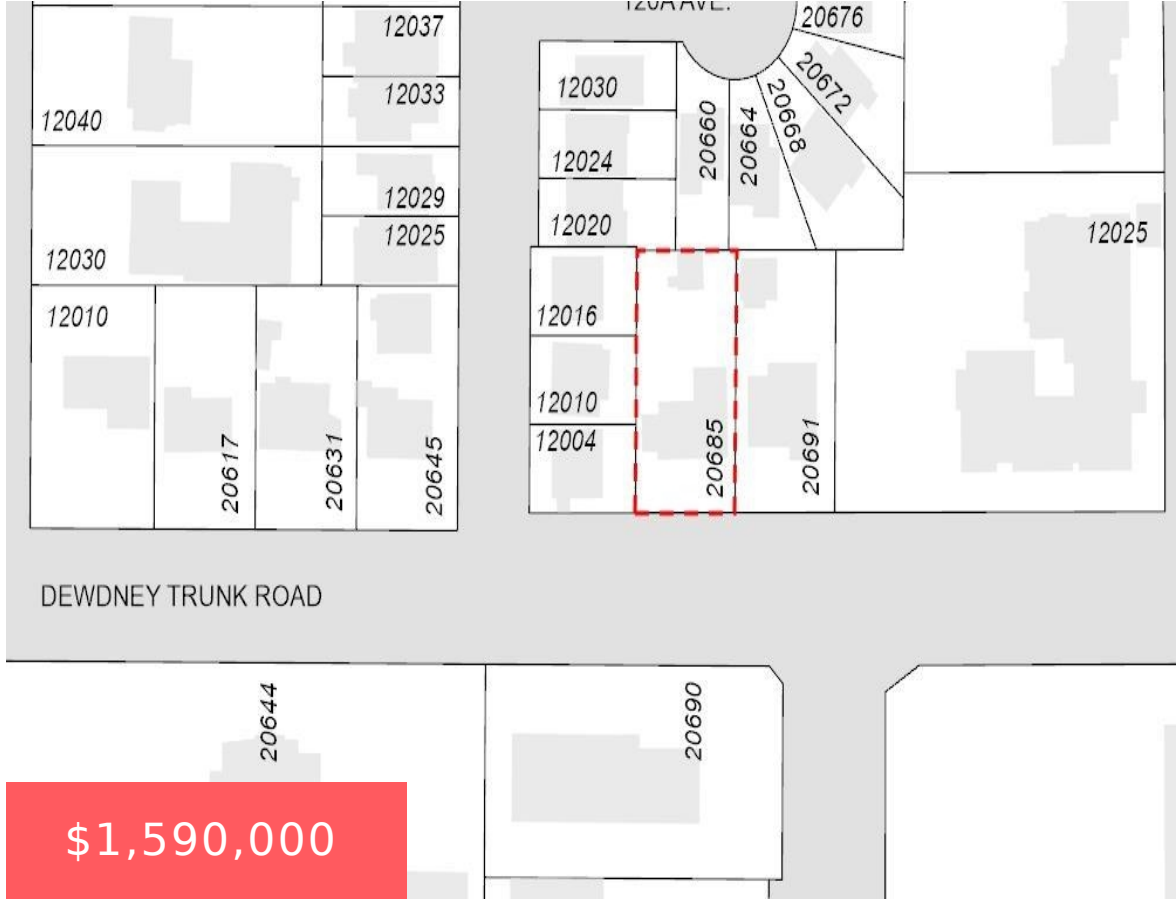

Property is located within the Lougheed Transit Corridor Neighbourhood Community Plan. (NCP) The NCP designates the property for Medium Density Multi-family Residential. Contact agent for more information.

- 3 beds
- 2 baths
- House/Single Family, Residential Detached
- Active
- Maple Ridge, Maple Ridge, Maple Ridge sq ft

## Building Details

Floor covering: 1172

